

PROPELLER ACCESSORIES

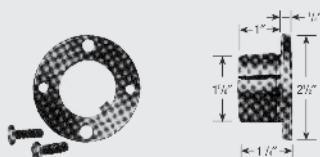

SPLIT TAPERED BUSHINGS FOR DESIRED BORE SIZE

- For 1/2" through 1 7/16" bore range
- Steel construction



H-STYLE

(FOR 24"-48" PROPELLERS)

Part No.	Bore
60331504	1/2"
60331505	5/8"
60331506	3/4"
60331507	7/8"
60331508	1"
60331501	1 1/8"
60331502	1 1/16"
60331509	1 1/4"
60331503	1 3/8"

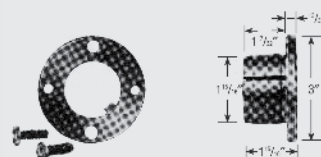

P-STYLE

(FOR 54"-60" PROPELLERS)

Part No.	Bore
72513808	1"
72513809	1 1/8"
72513810	1 1/4"
72513811	1 3/8"
72513812	1 3/16"
72513813	1 5/8"
72513815	1 7/16"

Standard Keyway Sizes

Diameter of Shaft	Keyseat Width X Depth
5/16 - 7/16	3/32 X 3/64
1/2 - 9/16	1/8 X 1/16
5/8 - 7/8	3/16 X 3/32
15/16 - 1 1/4	1/4 X 1/8
1 5/16 - 1 3/8	5/16 X 5/32
1 7/16 - 1 1/2	3/8 X 3/16
1 13/16 - 2 1/4	1/2 X 1/4

Measurements in inches.

Split Tapered Bushings must be ordered separately

INTERCHANGEABLE HUBS FOR 3, 4 & 5-BLADE PROPELLERS

(Order Separately)

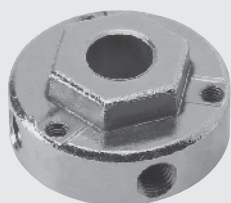

Includes set and mounting screws

Part Number	Bore	Set Screw
60765801	1/4"	1
60765802	5/16"	1
60765803	3/8"	1
60765804	1/2"	2
60765805	5/8"	2
60765806	3/4"	2

- All steel with extra metal for durability in the two mounting surfaces (hex & round)
- One inventory for all propellers – hex on one side, round on the other (use either)
- 5/8" and 3/4" models have keyway with extended body length for increased strength
- Double locking device grips threads without backing out
- Order in boxes of 12 or individually

INTERCHANGEABLE HUBS FOR HUBLESS PROPELLERS

(Order Separately)

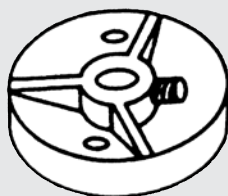

Includes set and mounting screws

Part Number	Bore
05382501	1/4"
05382502	5/16"

Lau HEX design transfers the torque from the screws to the hub and spider.

SPIDER

HUB MOUNTING FLANGE

GOOD

EXCELLENT

NO HOLDING POWER AT HUB MOUNTING FLANGE, ONLY AT MOUNTING SCREWS.

ROUND

HUB O.D.

HEX

HOLDING POWER AT EACH HEX POINT AND MOUNTING SCREWS

Specifications are subject to change without notice or obligation