

2011

Parts & Accessories

for water heating systems

Preferred Parts

The premium line approved for replacement in

- Rheem® and Ruud® residential water heaters
- Rheem®-Ruud® commercial water heaters
- Richmond® residential water heaters
- PerfectFit™ commercial water heaters
- GE and Hotpoint residential water heaters

Universal Parts

- The value line for all your replacement parts
- Fits most brands of water heaters

Tools & Accessories

- Supplies that help with any job



National Parts service center
from Rheem



relax
It's Rheem®

Listings, Diagrams,
Reference Guide, Displays
and more!

AdvantagePlus Commercial Gas

After 6/1/2009



**PARTS DIAGRAM
ON PAGE 70**

- **Gasket – Burner Mounting Flange**
SP15138
- **Igniter w/ Gasket & Mounting Screws (NG)**
SP15128
- **Igniter w/ Gasket & Mounting Screws (LP)**
SP15134
- **Flame Sensor w/ Gasket & Mounting Screw**
SP15129
- **Gasket – Burner Blower**
SP15239
- **Burner w/ Gasket**
SP15126 (130k btu or less)
SP15127 (>130k btu)
- **Gasket – Burner Mounting Plate**
SP15139
- **Gasket – Sight Glass**
SP15152
- **Sight Glass w/ Gasket**
SP15136
- **Combustion Blower w/ Gasket**
SP15130
- **Air Intake Adapter – Blower Side**
SP15158
- **Air Intake Adapter – Valve Side**
SP15157
- **Swirl Plate**
SP15155 (130k btu or less)
SP15156 (>130k btu)
- **Condensate Neutralizer**
SP12151
- **Mesh Screen for 3-Inch Pipe**
SP12163
- **Gas Valve Assembly**
SP15131 (130k btu or less)
SP15132 (>130k btu)
- **Pressure Switch**
SP12140
- **Over Temperature Switch – Outlet**
SP12149
- **Tube – Air Inlet**
SP15137
- **Main Control Board – 160°F**
SP15133A (130k)
SP15133B (160k)
SP15133C (199k)
SP15133D (100k)
- **Main Control Board – 180°F**
SP15133A (160E)
SP15133B (199F)
- **Control Board Display**
SP15153
- **ECO/Temperature Probe**
SP12142
- **Low Water Cutoff**
SP15140
- **Low Voltage 24V Cable**
SP15183
- **Line Cable – 120V**
SP15184
- **Aluminum Vent Kit**
SP12162 (Outsize Aluminum)
- **PVC Vent Kit**
Call for Application
- **Model 450 CO Meter**
AP12516

Commercial Replacement Parts List

ADVANTAGE PLUS

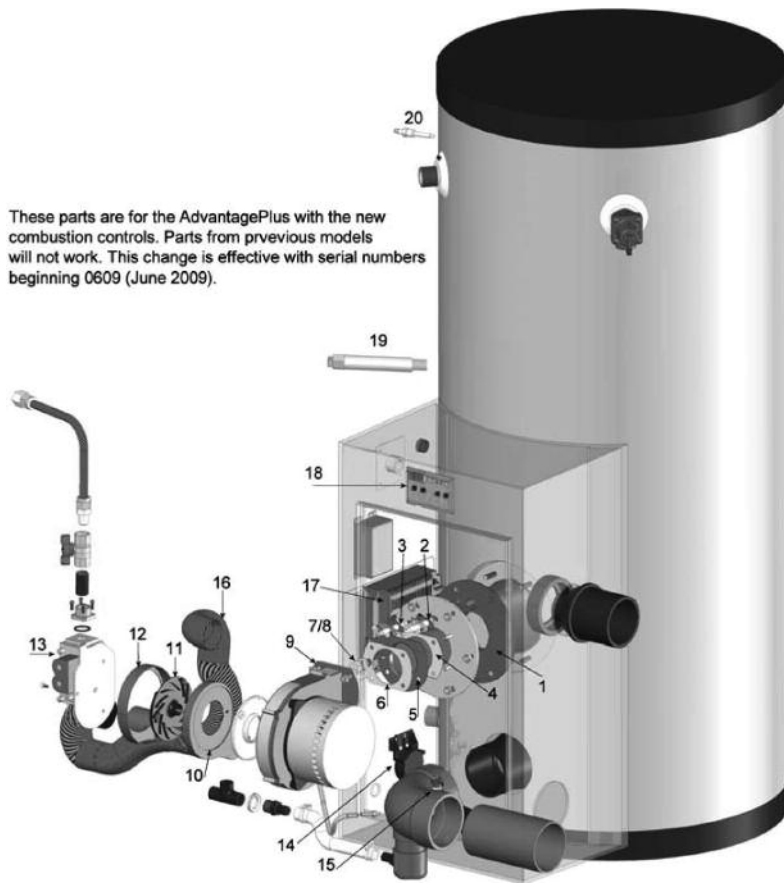

These parts are for the AdvantagePlus with the new combustion controls. Parts from previous models will not work. This change is effective with serial numbers beginning 0609 (June 2009).

Ref. No.	Part Description	Part Number
1.	Gasket – Burner Mounting Flange	SP15138
2.	Igniter w/ Gasket and Mounting Screw – Natural	SP15128
	Igniter w/ Gasket and Mounting Screw – Propane	SP15134
3.	Flame Sensor w/ Gasket and Mounting Screw	SP15129
4.	Gasket – Burner / Blower	SP15239
5.	Burner w/ Gasket – 130k btu or less	SP15126
	Burner w/ Gasket – Greater than 130k btu	SP15127
6.	Gasket – Burner / Mounting Plate	SP15139
7.	Gasket, Sight Glass	SP15152
8.	Sight Glass with Gaskets	SP15136
9.	Combustion Blower w/ Gasket	SP15130
10.	Air Intke Adapter – Blower Side	SP15158
11.	Swirl Plate – 130k btu or less	SP15155
	Swirl Plate – Greater than 130k btu	SP15156
12.	Air Intake Adapter – Valve Side	SP15157
13.	Gas Valve Assembly – 130k btu or less	SP15131
	Gas Valve Assembly – Greater than 130k btu	SP15132
14.	Pressure Switch	SP12140
15.	Over Temp. Switch – Outlet	SP12149
16.	Tube – Air Inlet	SP15137

Ref. No.	Part Description	Part Number
17.	926 Main Control Board – 160°F. 130k	SP15133A
	926 Main Control Board – 160°F. 160k	SP15133B
	926 Main Control Board – 160°F. 199k	SP15133C
	926 Main Control Board – 160°F. 100k	SP15133D
	926 Main Control Board – 180°F. 160k	SP15133E
	926 Main Control Board – 180°F. 199k	SP15133F
18.	Control Board Display	SP15153
19.	ECO / Temperature Probe	SP12142
20.	Low Water Cut-off	SP15140
	Parts not Shown	
NS	Low Voltage 24V Cable	SP15183
NS	Line Cable 120V	SP15184
NS	Gas Conversion Kit – Propane to Nat. Kit	SP15159
NS	Gas Conversion Kit – Nat. to Propane	SP15160
NS	Use and Care Manual	AP15135
NS	Concentric Vent Kit – 3 Inch	SP20245
NS	Aluminum Outside Vent Kit	SP12162
NS	Neutralizer, Condensate	SP12151
NS	Mesh Screen for 3" Pipe	SP12163
NS	Model 450 CO Meter (used for installation setup)	AP12516

To place your order call 1-800-621-5622; fax 1-800-535-9538