

# 5112-11/U Linkage Kit

## FOR N05, S03/05 DIRECT-COUPLED ACTUATORS

### SPECIFICATION DATA



#### Features

- Suitable for use with VBG2 Two-Way and VBG3 Three-Way Control Ball Valves as well as with N05xxx and S03xxx / S05xxx DCAs.
- Suitable for use in cold, warm, and hot water systems.
- For mediums with a temperature of +5 ...+120 °C (+41...+250 °F) and a max. pressure of 25 bar (360 psi).
- Allows the valve to be controlled during installation or in the event of a power failure.
- Actuator mounting plate can be rotated to different positions for installation in confined spaces.

#### Specifications

**Media temperature range** +5 ...+120 °C (+41...+250 °F)

#### Materials:

Plastic parts	PA6 + 30% GF
Screws	Carbon steel, corrosion-protected
Stem	Aluminum
Anti-rotation bracket	Aluminum

**Approvals/Standards** RoHS-compliant

## APPLICATION

The 5112-11/U Linkage Kit can be used for VBG2 Two-Way and VBG3 Three-Way Control Ball Valves (DN15-50) with N05xxx (DN15-50), S03xxx (DN15-32), and S05xxx (DN15-50) spring-return Direct-Coupled Actuators.

The manual operating handle allows the valve to be controlled during installation or in the event of a power failure.

## ASSEMBLY



### CAUTION

The pressure in the valve must first be reduced before performing any work.

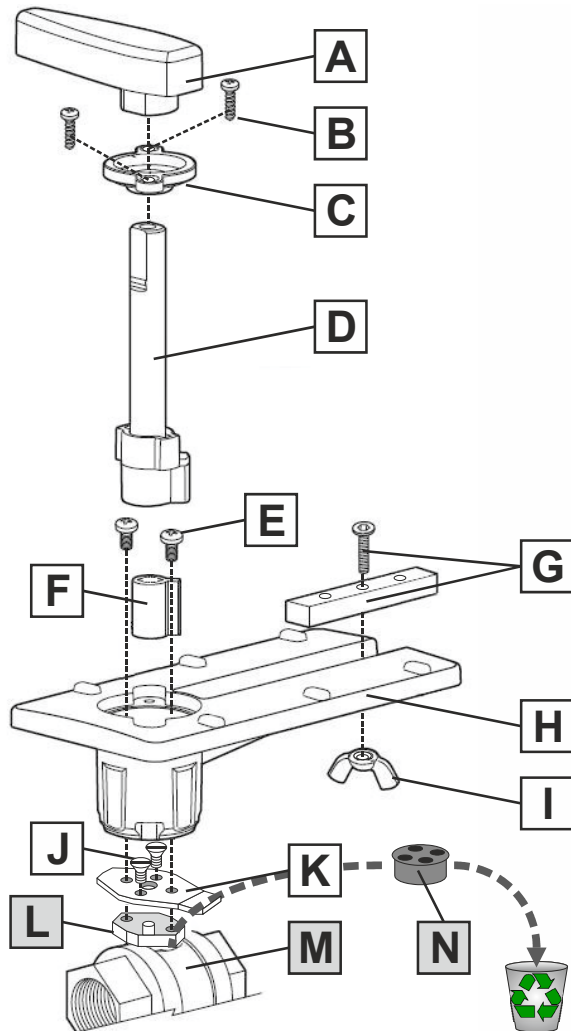

Fig. 1. Exploded view

Table 1. Legend for Fig. 1

A	Handle (removable) for manually rotating shaft
B	Screws, self-tapping (2X)
C	Stem assembly cover
D	Stem assembly
E	Screws, M4, pan head (2X)
F	Hold-down ring
G	Anti-rotation bracket and bolt
H	Mounting plate
I	Wing nut, self-locking
J	Countersunk screw, M4x5 (2x) Stem retainer
K	Valve stem retainer
L	Valve top (part of valve VBG)
M	Valve stem coupler (part of valve VBG)
N	Valve body (part of valve VBG)

### Mounting Plate Adjustment

The mounting plate can be rotated to a different position for installation in confined spaces. As a rule, ball valves are mounted against the right stop (closed). Proceed as follows (see Fig. 1):

1. Reduce the pressure in the valve.
2. Remove actuator linkage already in place.
3. Take care that the plastic ring located below the actuator linkage remains in place in the valve.
4. Using the 2 countersunk screws (J), mount the valve stem retainer (K) onto the valve.
5. Using the pan head screws (E), mount the mounting plate (H) onto the valve.
6. Check the orientation of the valve spindle and – if necessary – place in proper closing position (according to the valve's Mounting Instructions).
7. Insert the stem assembly (D) into the mounting plate (H) and snap onto the valve stem so that the stem assembly (D) is against the right (CW) stop.
8. Mount the stem assembly cover (C) onto the stem assembly (D) and secure using 2 self-tapping screws (B).
9. Mount the anti-rotation bracket (G) onto the actuator; do not yet tighten the fastening screws (M6 x 80 for S03/05; M5 x 20 for N05).
10. Bring the actuator to the right (CW) stop and mount onto stem assembly (D). Ensure that the actuator is parallel to the mounting plate (H).
11. Tighten the fastening screws (M6 x 80 for S03/05; M5 x 20 for N05) and tighten the wing nut (I) by hand using no tool.
12. Check for parallel mounting: The actuator must rest on all six support pads.
13. Snap on handle (A).

**Honeywell**  
THE POWER OF CONNECTED

Manufactured for and on behalf of the Connected Building Division of Honeywell Products and Solutions SARL, Z.A. La Pièce, 16, 1180 Rolle, Switzerland by its Authorized Representative:

#### Home and Building Technologies

Honeywell GmbH  
Böblinger Strasse 17  
71101 Schönaich, Germany  
Phone +49 (0) 7031 637 01  
Fax +49 (0) 7031 637 740  
<http://ecc.emea.honeywell.com>

EN0B-0769GE51 R1118

Subject to change without notice