



Description

The Model 14 is a compact, 5 figure, non-reset totalizer in a molded case with stainless steel shaft. Four types of drives are available and five case configurations. An ideal solution when application requirements call for a low cost and compact totalizer.

Features

- Four types of drives
- Choice of five case configurations
- Built-in non-overthrow mechanism on stroke counters
- Built-in internal stops on stroke counters
- 5 Figure: white on black background

Options

- Mounting
- Double shafts
- Figure background and case colors
- Sealed

Specifications

Figures: 5 figures, white on black, 0.16" [4mm] high
Reset: Non-reset
Rotation: Top-coming or top-going
Shaft Extension: Right-hand or left-hand
Shaft Diameter: 0.125" [3.2mm]
Speed: Stroke: 1,000 counts/minute
 Revolution: 3,000 counts/minute
 Direct: 15,000 counts/minute
 Rotary Ratchet:
 3,000 counts/minute rotary mode
 1,500 counts/minute in oscillating mode
Weight: 0.5 oz. [14g]
Temp: -40°F to +160°F [-40°C to +71°C]
Operating Torque: Stroke; 0.8 to 2.0 in/oz
 at 75°F Revolution; 0.15 in/oz
 Direct; 0.15 in/oz
 Rotary Ratchet; 0.3 to 1.0 in/oz

Case Types: Square base mount
 Square panel mount
 Square - no flange
 Cylindrical base mount
 Cylindrical panel mount

Drive Types:
Stroke: typical count stroke 39° to 48°
 typical total stroke 50° to 52°
Revolution: adds or subtracts one(1) count per revolution.
Direct: adds or subtracts ten (10) counts per revolution
Rotary Ratchet: adds ten (10) counts per revolution
 adds only one (1) count per 36° to 60° oscillation.

Models	Description				Models	Description			
11B-1415	lh, top coming,	stroke,	sq case,	base mt	11B-1435	rh, top coming,	stroke,	sq case,	base mt
11B-1515	lh, top coming,	rev. drive,	sq case,	base mt	11B-1535	rh, top coming,	rev. drive,	sq case,	base mt
11B-1615	lh, top coming,	direct drive,	sq case,	base mt	11B-1635	rh, top coming,	direct drive,	sq case,	base mt
11B-1715	lh, top coming,	rotary rat.,	sq case,	base mt	11B-1735	rh, top coming,	rotary rat.,	sq case,	base mt
11B-1425	lh, top going,	stroke,	sq case,	base mt	11B-1445	rh, top going,	stroke,	sq case,	base mt
11B-1525	lh, top going,	rev. drive,	sq case,	base mt	11B-1545	rh, top going,	rev. drive,	sq case,	base mt
11B-1625	lh, top going,	direct drive,	sq case,	base mt	11B-1645	rh, top going,	direct drive,	sq case,	base mt
11B-1725	lh, top going,	rotary rat.,	sq case,	base mt	11B-1745	rh, top going,	rotary rat.,	sq case,	base mt
	rat = ratchet					sq = square			
	rev = revolution					mt = mount			
	lh = left hand								
	rh = right hand								

Similar products are also available in the following configurations:

Square case - panel mount change 11B to 11P
 Square case - without flange change 11B to 11N
 Cylindrical case - base mount change 11B to 21B
 Cylindrical case - panel mount change 11B to 21P



Dimensions

Square Case Base Mount

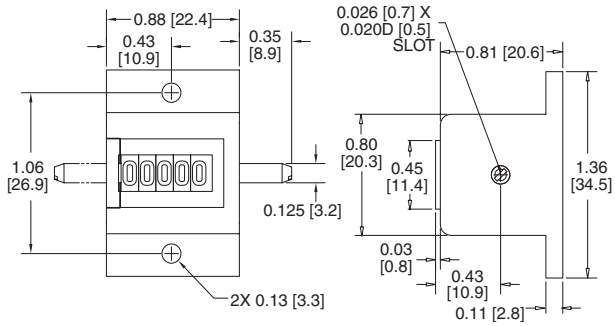

Square Case Without Flange

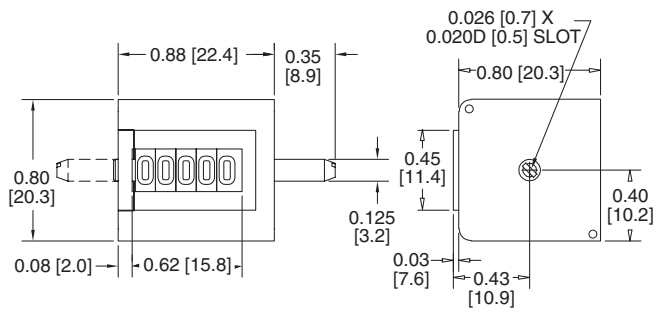

Square Case Panel Mount

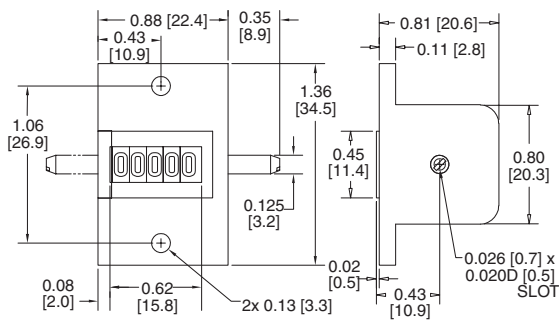

Cylindrical Case Base Mount

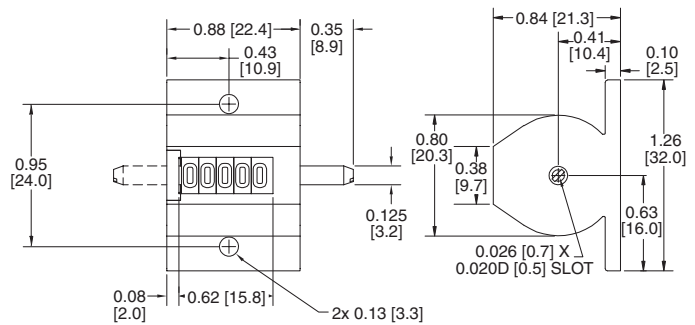

Cylindrical Case Panel Mount

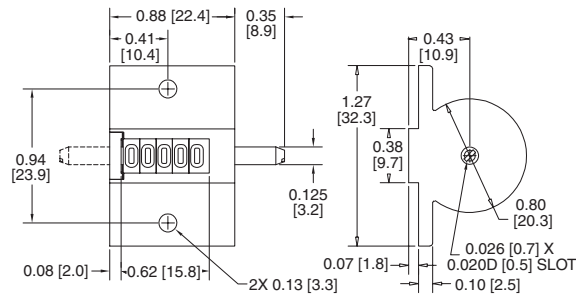

Short Lever (10006-028S)

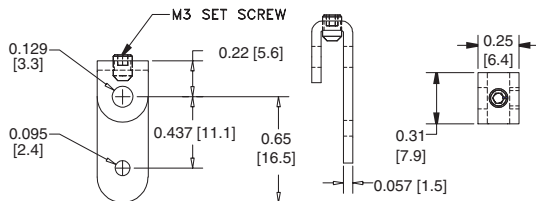

Standard Lever (10006-027S)

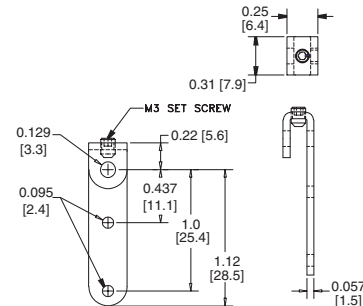

Applications

Circuit breakers



Vending machines



Gaming machines



Business and office equipment

